

INSTALLATION GUIDE
ARENA | STUDIO | ORIGINAL | MAX

Step 06

Plumb Up

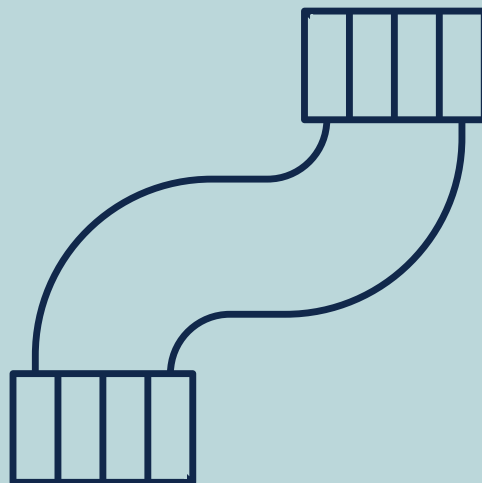

Our 8 step process to installing your Plungie

[Click here](#) to access the complete Plungie Install Guide.

Alternatively, you can click on any of the 8 icons below, each representing a specific step in the installation process.

Clicking on an icon will take you directly to the corresponding guide, allowing you to access the information you need quickly and easily.



Choose Plungie



Building Approval



Site Preparation



Crane Hire + Delivery



Electrical + Backfill



Plumb Up



Finishings + Surrounds



Fill + Start Up

This information is offered as a general guide only, and specific advice should always be sought by engaging with an engineer before undertaking any installations specific to your site.

Whilst Plungie Pty Ltd has made every effort to ensure the accuracy and effectiveness of this information, we make no representation as to the accuracy or effectiveness of the information and take no responsibility for any loss, damage or injury which may be caused as a direct or indirect result of the use of this information.

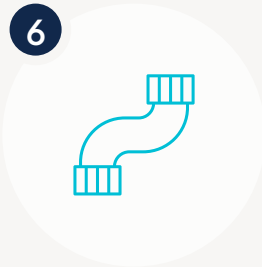

Step 06 Plumb Up

☐ ALLOW PROVISIONS FOR EQUIPMENT

Ensure required power provisions are made available for the equipment package.

☐ EQUIPMENT PAD (Pump, Filter, Chlorinator)

☐ PLUMB UP Engage your plumber for the secondary plumbing and to connect your equipment. [+ Plumbing Guide](#)

The content provided in this guide is part of an 8 step process extracted from the [Plungie Install Guide](#)

This guide is intended to provide you with a brief overview of this step, within our 8 step process. However, it's important to note that this excerpt should be read in conjunction with our more detailed guide and engineering set.

The more detailed guide and engineering set contain critical information that will help ensure a successful installation, and we highly recommend that you refer to them throughout the process.

By doing so, you'll have access to all the necessary information, including installation diagrams, specifications, and step-by-step instructions.

So, let's get started!



This guide is continually updated, please ensure you are accessing it via the link provided to ensure you are viewing the latest copy.

Step 6

Plumb Up

Plumb Up	43
Plumbing Guide: Provision Labels / Index	44
Five internal provision configuration	45
Spa Configuration	49
Spa Jets Internal Provisions	50
Fire Provision	52
Accessory Holder	54
Auto Fill	56
Equipment Guides + Troubleshooting	57
Standard Equipment Configuration	58
LED Light Connection	60
Water Overflow Provision	61

GET READY TO...

- ☐ Ensure required power provisions are made available
- ☐ Plumb Up
- ☐ Connect Equipment

Plumb Up

Every Plungie is supplied with its primary plumbing fixtures pre-fitted. This includes the skimmer box and provisions for general filtration.

The pool will then require a plumb-up service to connect the general filtration equipment to these pre-fitted provisions. Depending on the chosen equipment, this can be completed by a pool service professional, builder, pool builder, or a plumber.

However, the plumbing configuration means that you do not need a plumber on site at time of delivery. It’s as simple as craning into place, leaving the construction cover on and allowing you to work around the pool safely during construction.

Once plumbing and electrical is complete, you can begin the backfill process.

Please note: Schedule 40 PVC piping must be used for the pipe runs.

A standard equipment package can also be included when purchasing your Plungie including pump, chlorinator and filter.

PUMP LOCATION

We recommend the location of your pump to not exceed 40 foot distance from your pool. If it exceeds this distance you may require a more powerful pump or to run the pump for a longer duration to achieve the same results.

Refer to the product specification sheet from your pump manufacturer for a performance chart.

PLUNGIE WILL SUPPLY YOU WITH:

- All primary plumbing (skimmer box, hydrostatic valve and filtration returns)



You will be required to:

- Ensure equipment pad has been installed
- Ensure that the required power provisions are made available for the equipment package to run
- Standard package requires a 15amp double GFCI
- Equipment pad with 2 ft clearance is recommended to house your equipment. If your pool is out of the ground, the stair void is the perfect location.
- Photograph pipe runs from pool pre-plumbing to the pool equipment.
- Pressure testing of complete pipe runs from internal fittings to the equipment, holding 25 PSI as per local requirements.

Plumbing Guide

Provision Labels + Usage

REGULAR PROVISIONS	DIAMETER	FUNCTION
<div>A</div> SKIMMER SUCTION	2 inch	Main pipe from the skimmer box to pool equipment providing chlorination and filtration.
<div>B</div> RETURNS	1.5 inch	Primary return plumbing returning water from chlorination and filtration through eyeball outlets.
<div>C</div> SAFETY SUCTION	2 inch	Safety suction provision for use when second pump requirements are needed (additional to skimmer).
<div>D</div> LED LIGHT	2 ¾ inch	Wiring for pre-fitted LED light. Requires connection to supplied transformer and electricity supply. Conduit from the pool, light cable.

OPTIONAL PROVISIONS	DIAMETER	FUNCTION
<div>E</div> SPA JET	1.5 inch	Provisions must be specified at time of order, to allow for the addition of spa jets.

ARENA

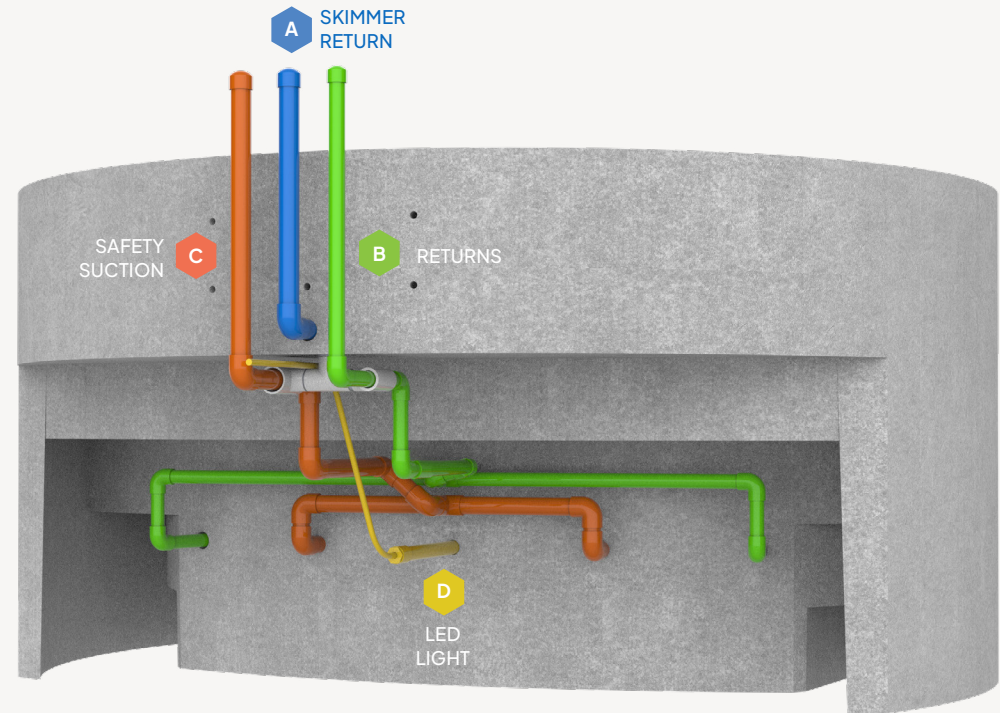

STUDIO

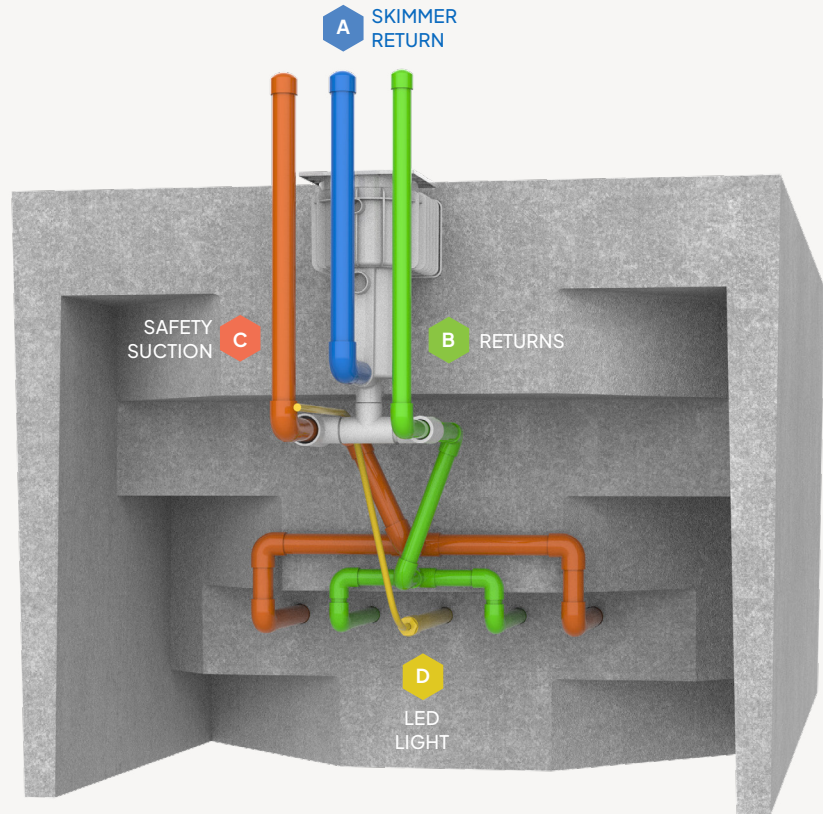

ARENA

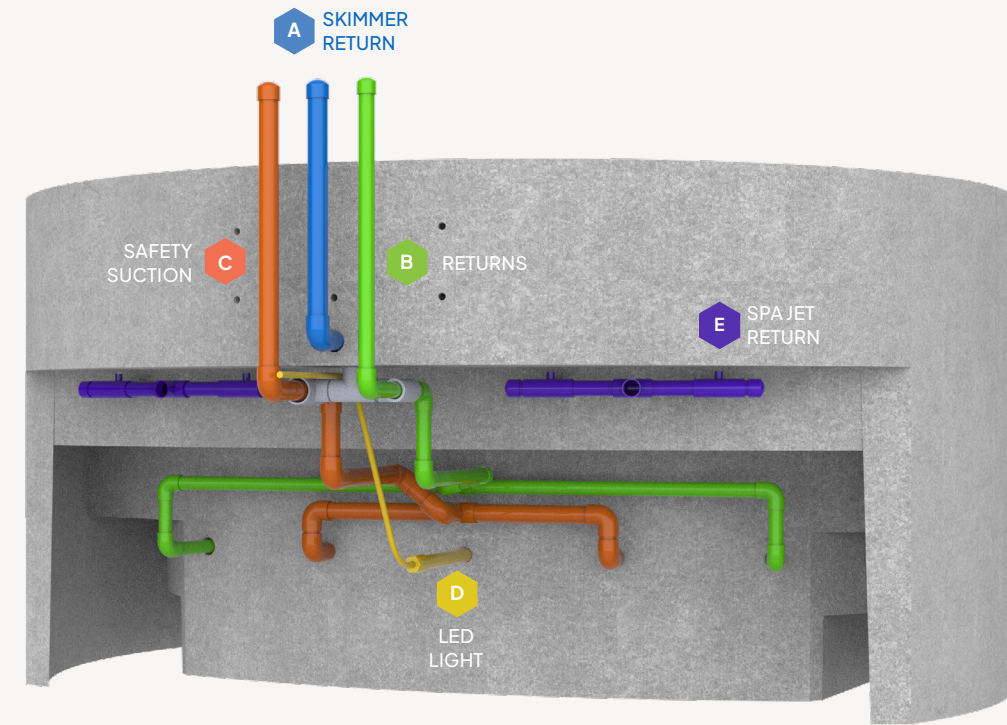

STUDIO

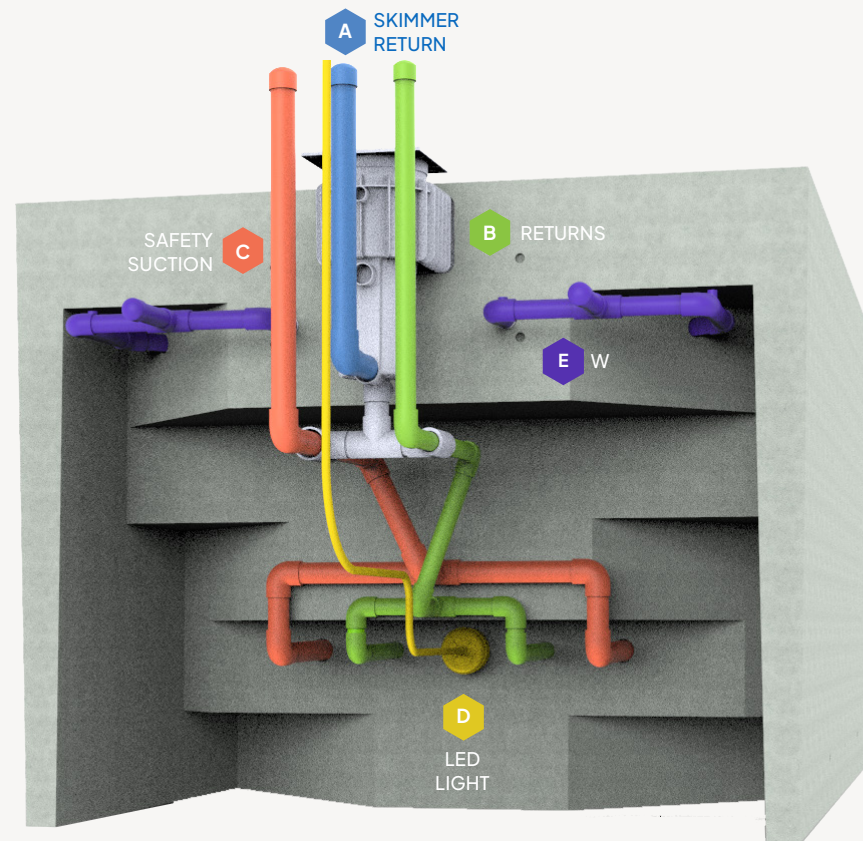

ORIGINAL

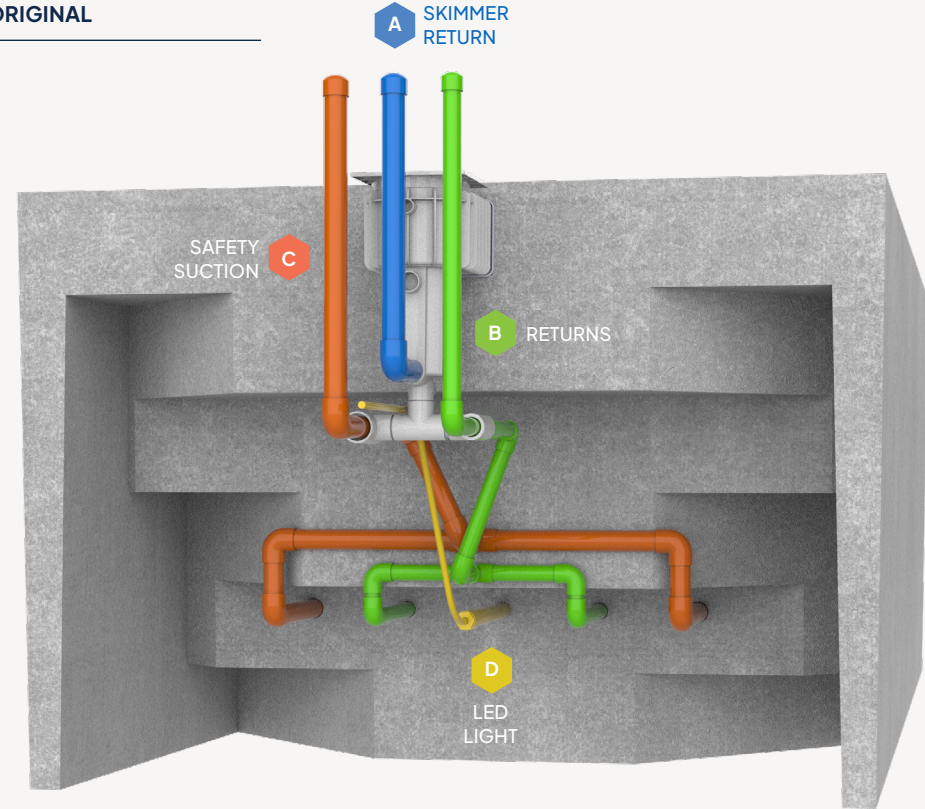

MAX

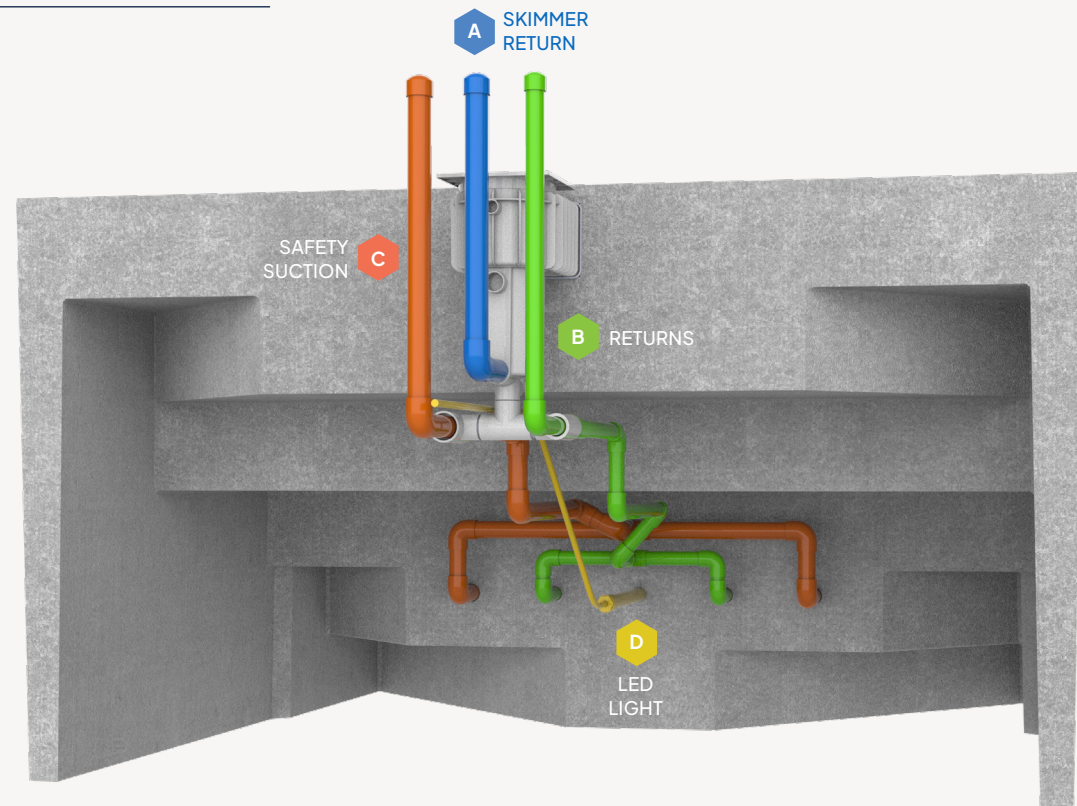

5 Internal Provisions + Spa Jets

ORIGINAL

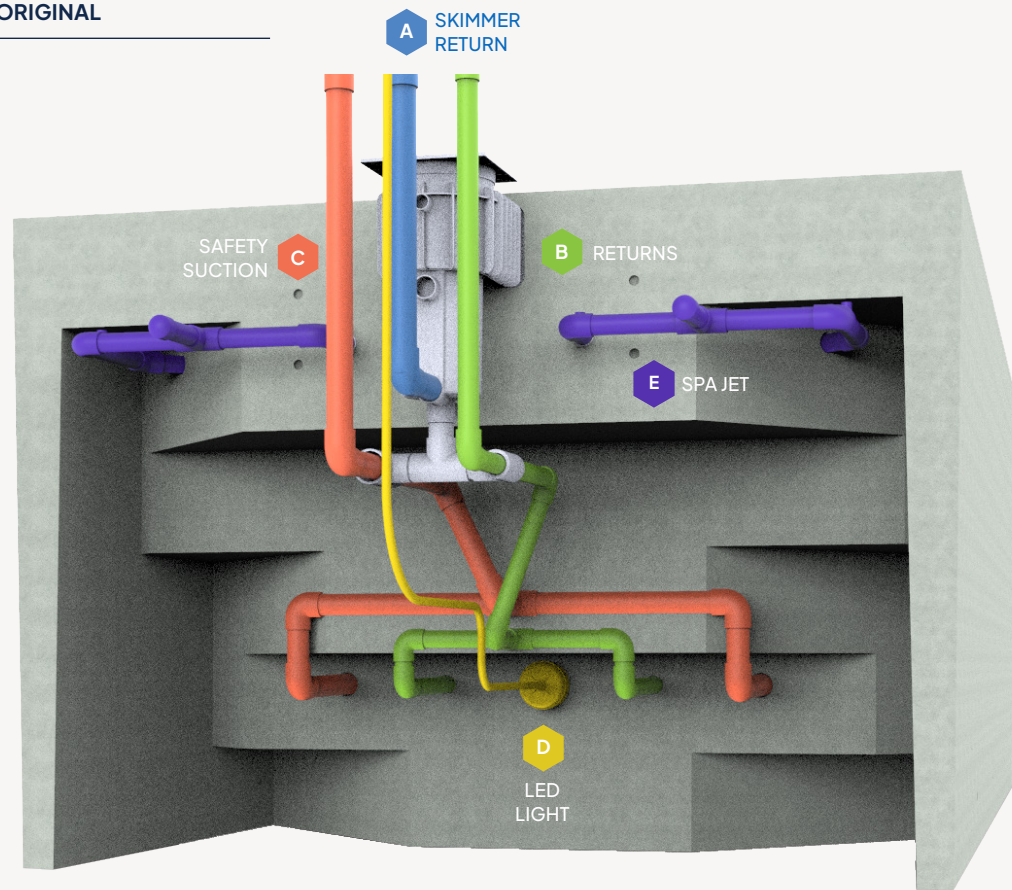

MAX

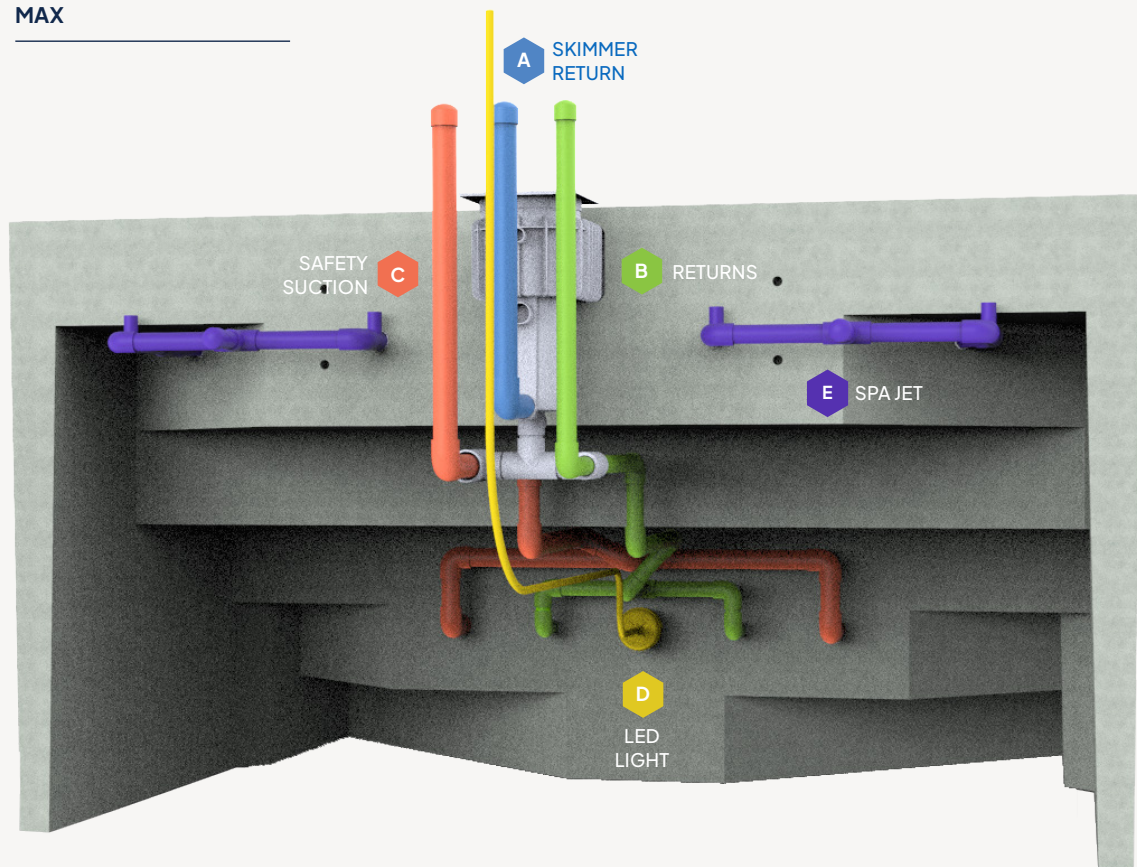

Spa Configuration

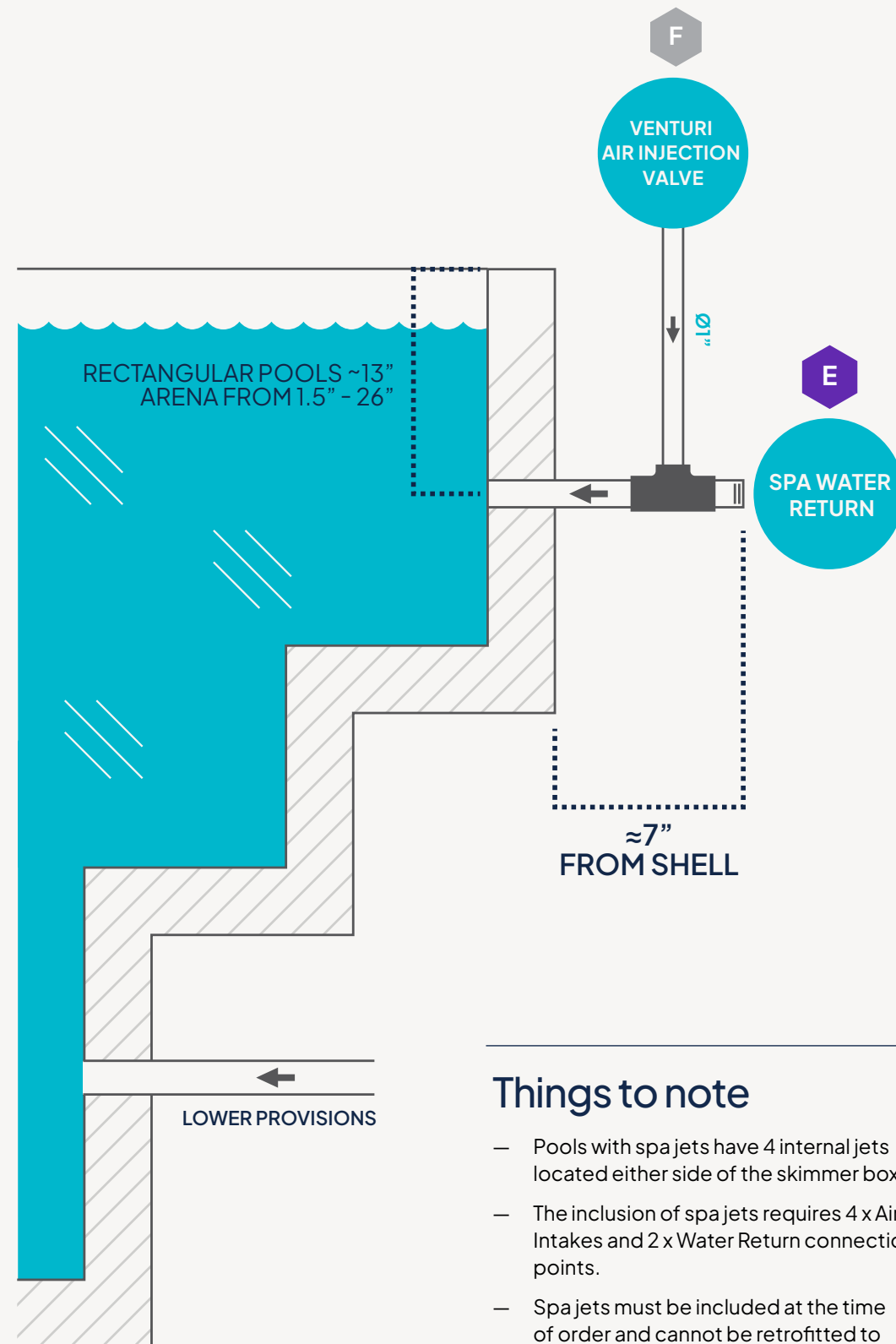

Things to note

- Pools with spa jets have 4 internal jets located either side of the skimmer box.
- The inclusion of spa jets requires 4 x Air Intakes and 2 x Water Return connection points.
- Spa jets must be included at the time of order and cannot be retrofitted to finished pool shells.
- All spa jets need to be plumbed up into one return line to maintain maximum pressure between all jets evenly.

Spa Jets **Internal Provisions**

ORIGINAL

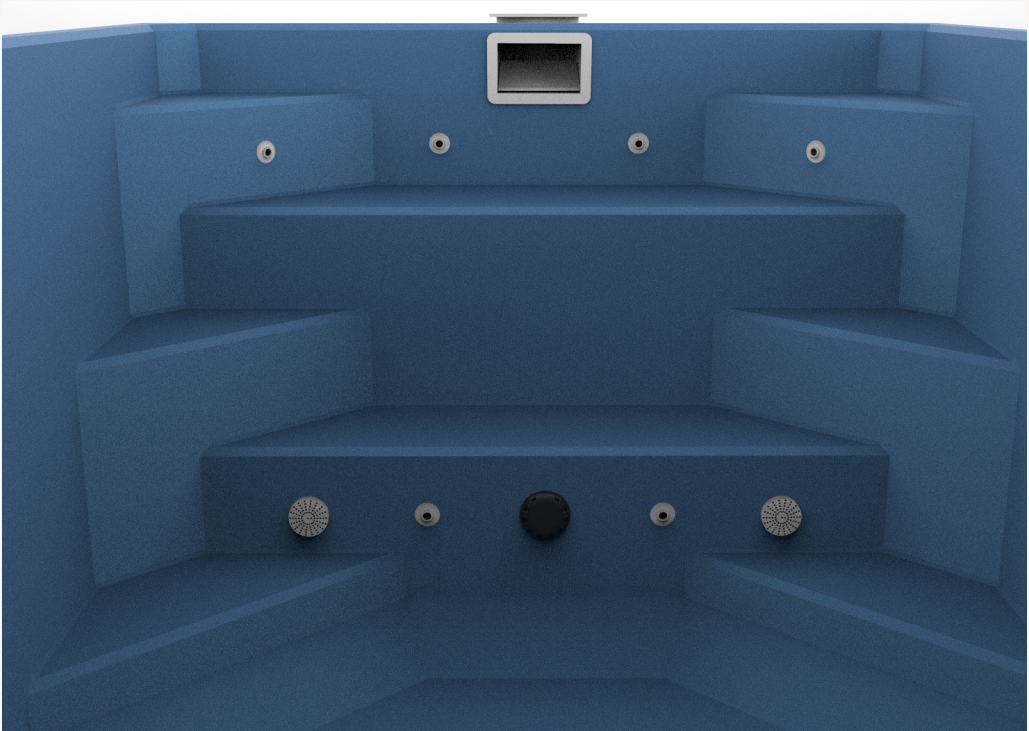

MAX

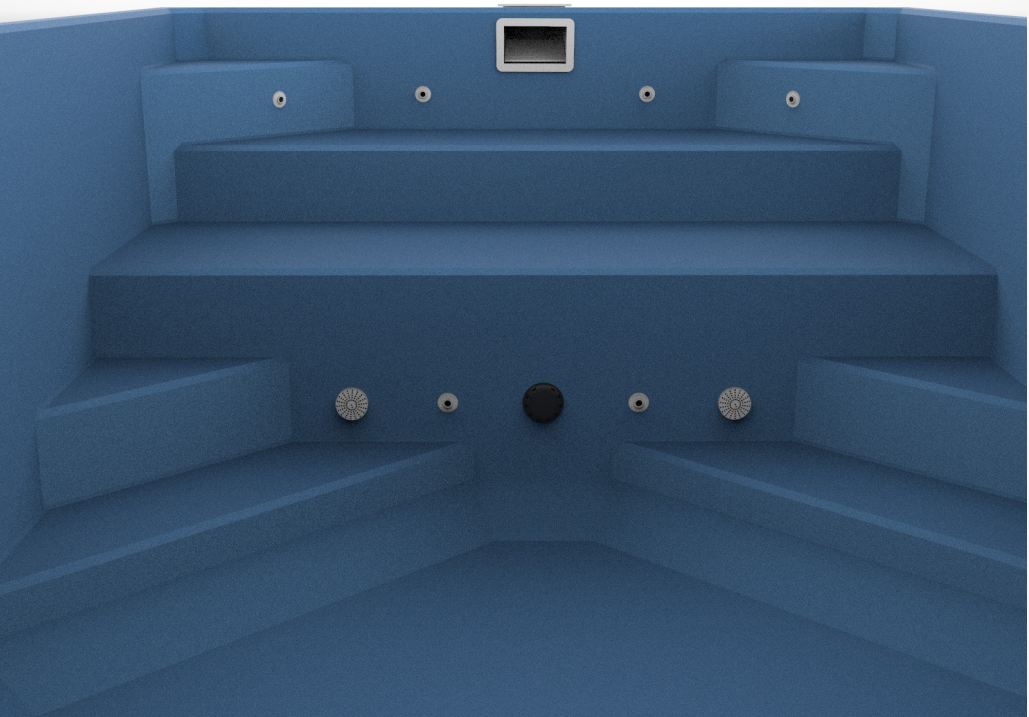

ARENA

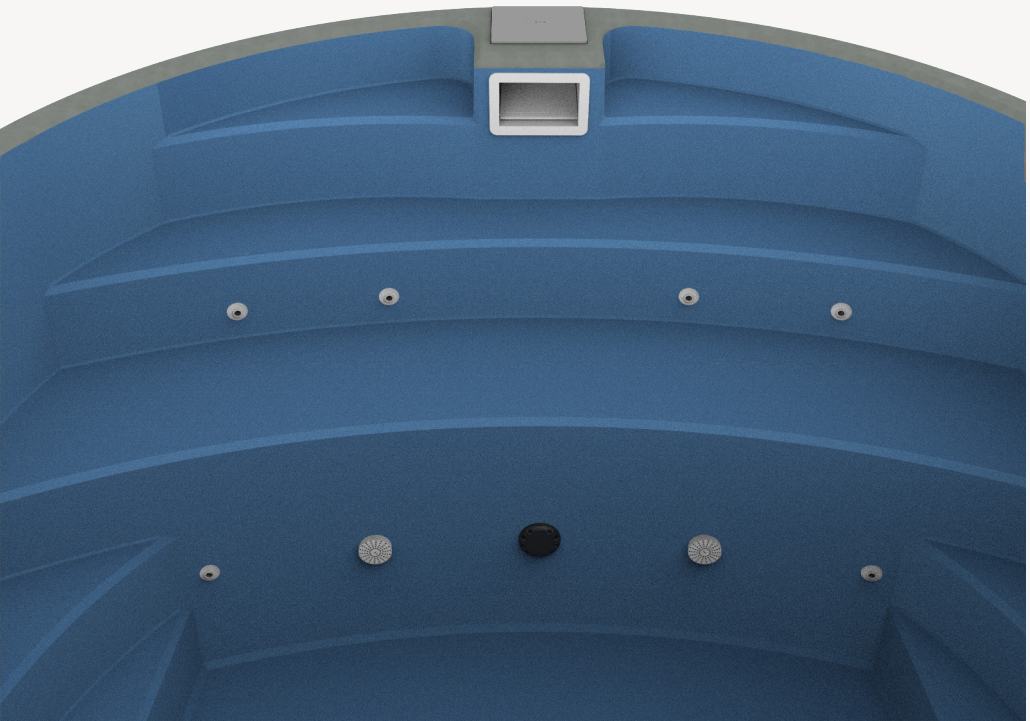

STUDIO

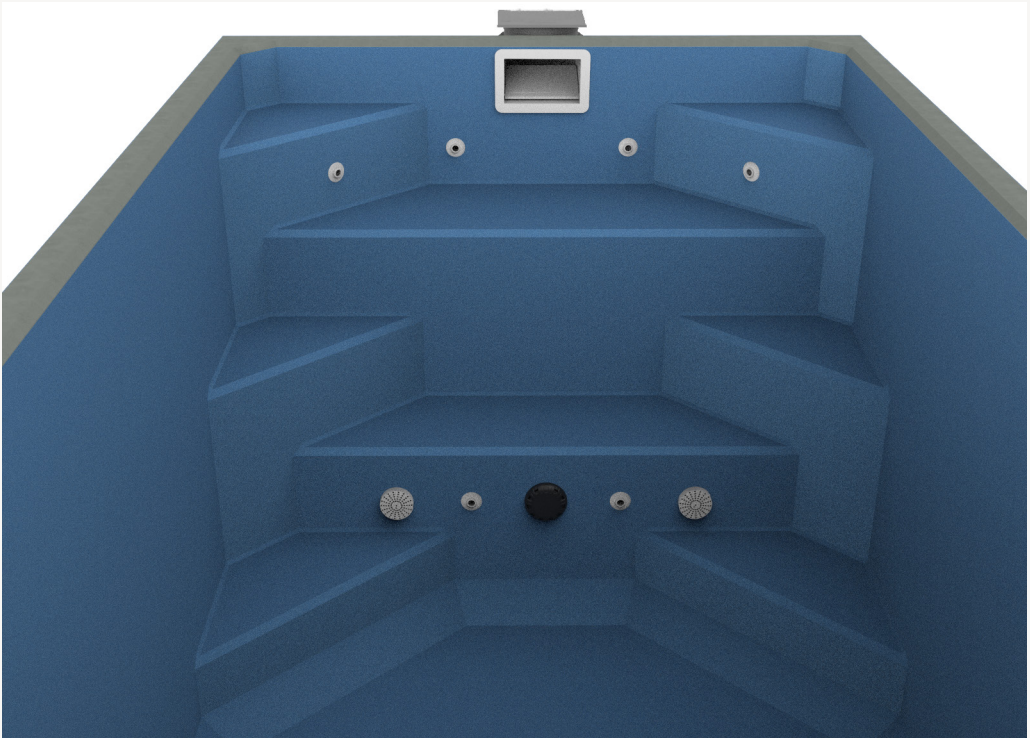

Spa Jets **Internal Provisions**

Fire Provisions

WHAT EXACTLY IS A FIRE PROVISION?

A fire provision is a small modification that can be made to the pool shell, allowing it to be used as a firefighting water source. This provision provides for two additional suction points, which allows a valve to be added to the pool, which can ultimately be connected to a hydrant or pump connection for firefighting.

In the past, we received requests from homeowners in wildfire-prone areas to add a fire provision to their Plungie. We thought this was a great idea, and in the spirit of continuous improvement, we've introduced this as a standard modification that can be added to our Original and Max models.

CAN A FIRE PROVISION BE ADDED TO ALL PLUNGIE MODELS?

We offer fire provisions on our Original and Max models as they are the ideal size for a static water supply for your property. After all, the Max is the world's largest monolithic pre-cast concrete swimming pool! Like most of our add-ons and modifications, a fire provision must be requested at the time of ordering and cannot be retrofitted.

ORIGINAL

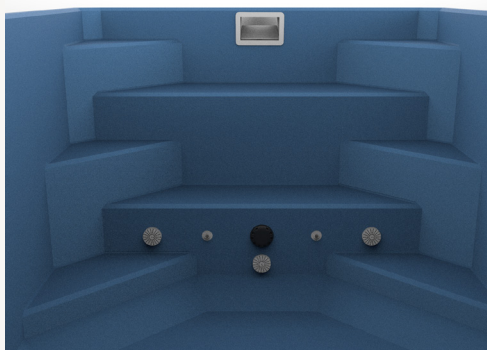

MAX

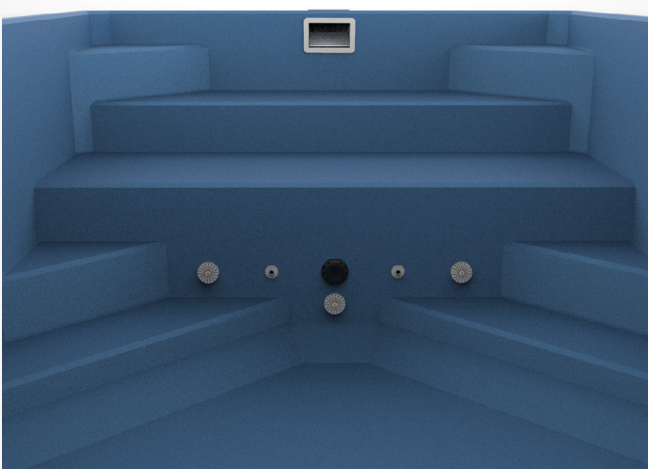

PLUMBING REQUIREMENTS

You can plumb the fire provision to wherever you like in your yard, so it won't impact your landscape design. Simply ensure that it can be easily accessed by firefighters, and install the applicable connection point for your state.

IS THE FIRE PROVISION COMPLIANT IN MY STATE?

Each state and territory has specific requirements for the valve that is attached to the fire provision — rather than the provision itself. Our fire provision provides the basic connections, which your plumber can commission the appropriate state-approved valve, so you can take advantage of this modification no matter where you're installing a Plungie.

ORIGINAL

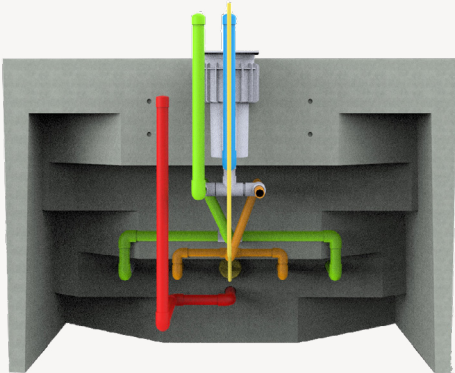

ORIGINAL

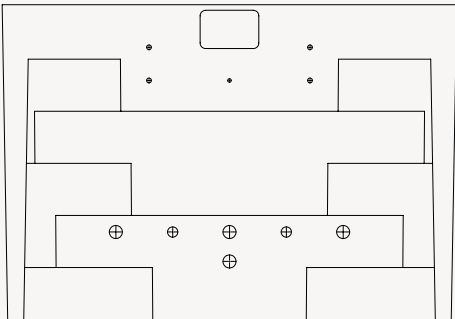

MAX

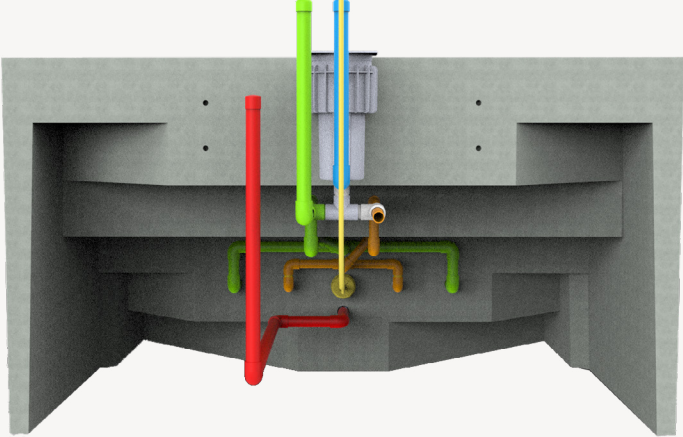

MAX

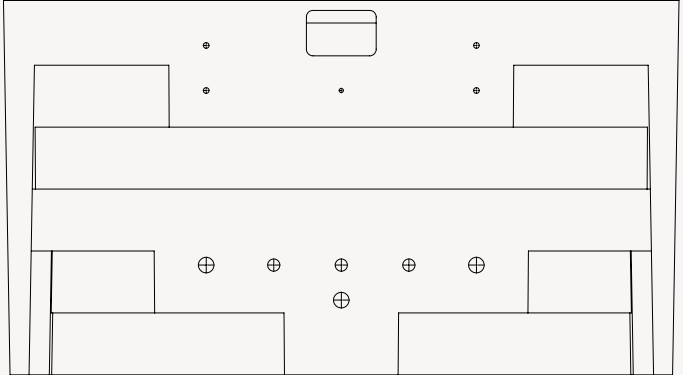

Accessory Holder

WHAT IS AN ACCESSORY HOLDER:

A multi-function insert in the step of the pool that securely holds accessories with diameters ranging from 1 1/2 - 2 inches in diameter. The insert sits flush with the step surface when not in use and has a removable cap and sleeve to reduce the diameter from 2 - 1 1/2 inches.

CAN ACCESSORY HOLDERS BE ADDED TO ALL PLUNGIE MODELS?

The Accessory Holder can be added to all pools with x3 location options available on both the top step and 2nd step/beach step. Refer to the Accessory Holder drawings for approximate locations.

PLUMBING REQUIREMENTS:

The Accessory Holder requires no additional plumbing.



THINGS TO NOTE

Care must be taken when inserting accessories into the holder. Accessories must be gently lowered into the holder without dropping. We recommend only using authorized Plungie accessories and not placing any foreign objects into the holders.

Accessory holders must be specified at time of order.

LOCATION OF ACCESSORY HOLDERS FOR PLUNGIE MAX

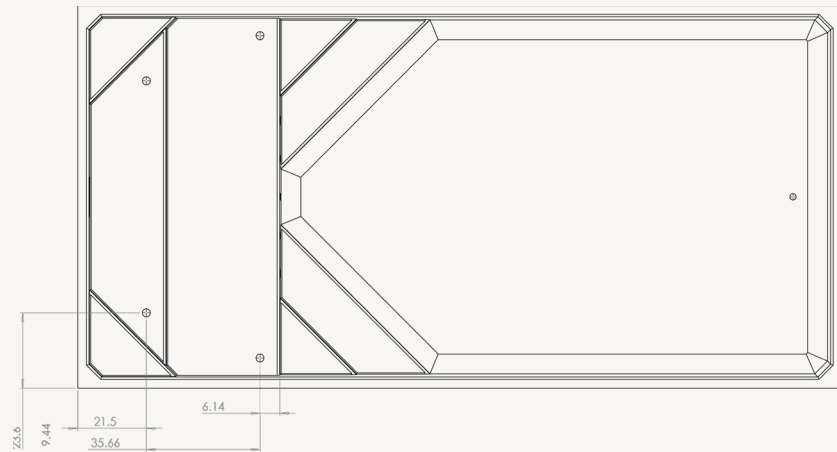

LOCATION OF ACCESSORY HOLDERS FOR PLUNGIE ORIGINAL

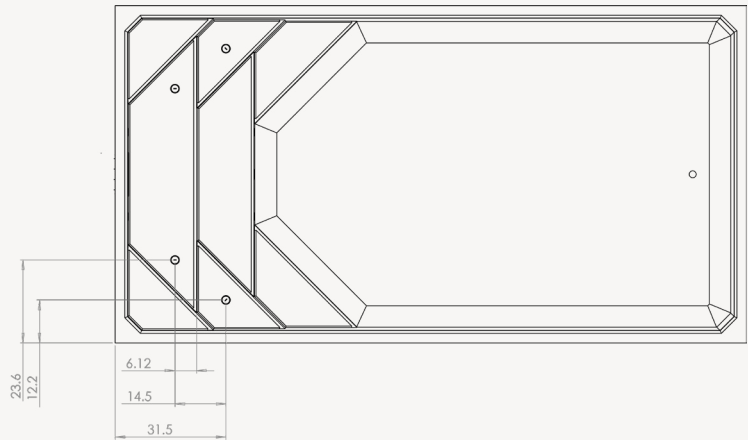

LOCATION OF ACCESSORY HOLDERS FOR PLUNGIE STUDIO

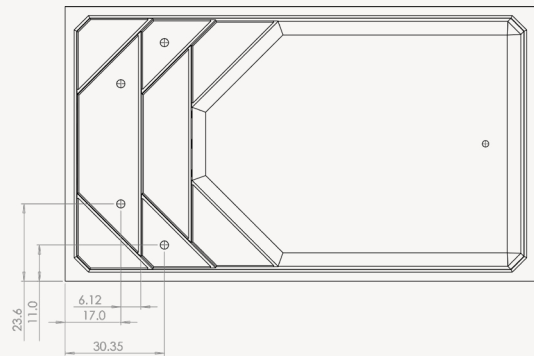

LOCATION OF ACCESSORY HOLDERS FOR PLUNGIE ARENA

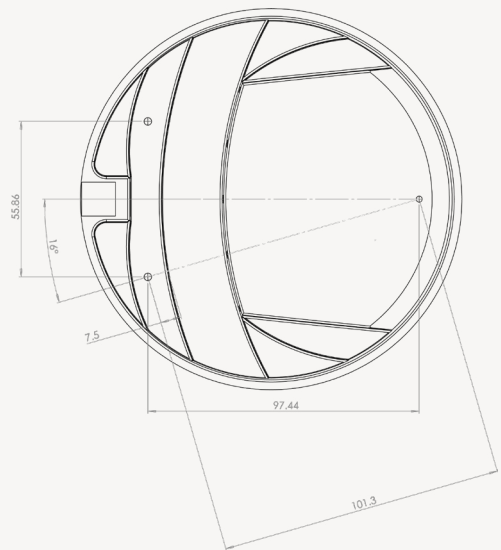

Auto Fill

WHAT IS A AUTO FILL DEVICE?

The Auto Fill Device is a valve specifically designed to control the top up of water in pools automatically. The positive shut off feature functions in a 5–150psi/30–550kPa water pressure range with a flow rate of 80% of that supplied to the valve. The valve will shut off approximately 1/2 inch from the bottom of the valve and has a 3/4 inch BSP Nylon male connection.

CAN AN AUTO FILL DEVICE BE ADDED TO ALL PLUNGIE MODELS?

The Auto Fill Device can currently only be added to the Plungie Max, Plungie Original and the Plungie Studio.

PLUMBING REQUIREMENTS:

The Auto Fill Device has a 3/4 inch Male BSP Nylon connection. We recommend using plumbing tape on all threaded connections and a licensed plumber if connecting to mains water.

AUTO FILL DEVICE

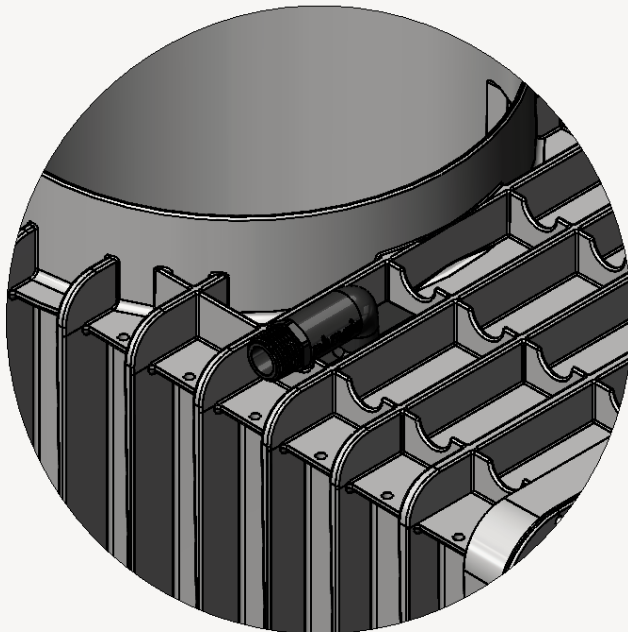
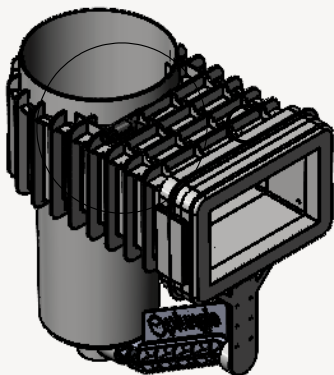

THINGS TO NOTE

The Auto Fill Device will be triggered by fluctuations in water levels. To minimize the device turning on during swimming a timer may be plumbed to only allow water flow to the device outside of normal swimming times.

Must be specified at time of order.

Equipment Guides

FILTRATION EQUIPMENT PACKAGES

SMART EQUIPMENT PACKAGE

Pump: [MaxFlo 500 with OmniHub](#)

Filter: [Cartridge Filter 150S](#)

Chlorinator: [CL200S](#)

SALT EQUIPMENT PACKAGE

Pump: [MaxFlo 500 VS](#)

Filter: [Cartridge Filter 150S](#)

Smart Chlorinator: [Aquarite with OmniHub](#)

AOP+UV EQUIPMENT PACKAGE

Pump: [MaxFlo 500 with OmniHub](#)

Filter: [Cartridge Filter 150S](#)

Chlorinator: [CL200S](#)

Hydrapure: [AOP Ozone & UV](#)

HEATER UNIT

Heater: [Dual Fuel Heater](#)

SPA JETS EQUIPMENT

[TriStar 900 with OmniHub](#)

[Spa Blower, 1.5 hp](#)

CHILLER

[AquaComfort Electric Chiller](#)

HAYWARD EQUIPMENT

For information related to Hayward equipment, please refer to the Hayward website directly:

www.hayward.com

EQUIPMENT WARRANTY LINKS

Depending on your brand of equipment, you will need to click on the correct link below and complete the warranty form on their own site.

[+ Hayward](#)

[+ AquaComfort AquaChill](#)

WHEN INSTALLED ABOVE WATER LEVEL

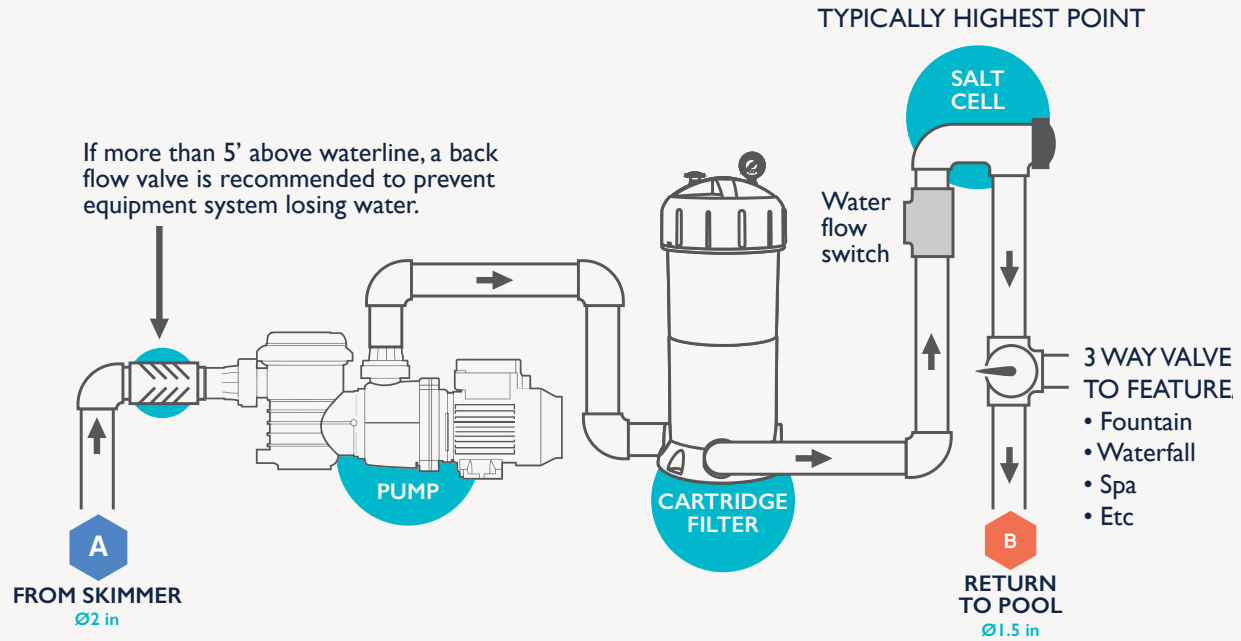

WHEN INSTALLED BELOW WATER LEVEL

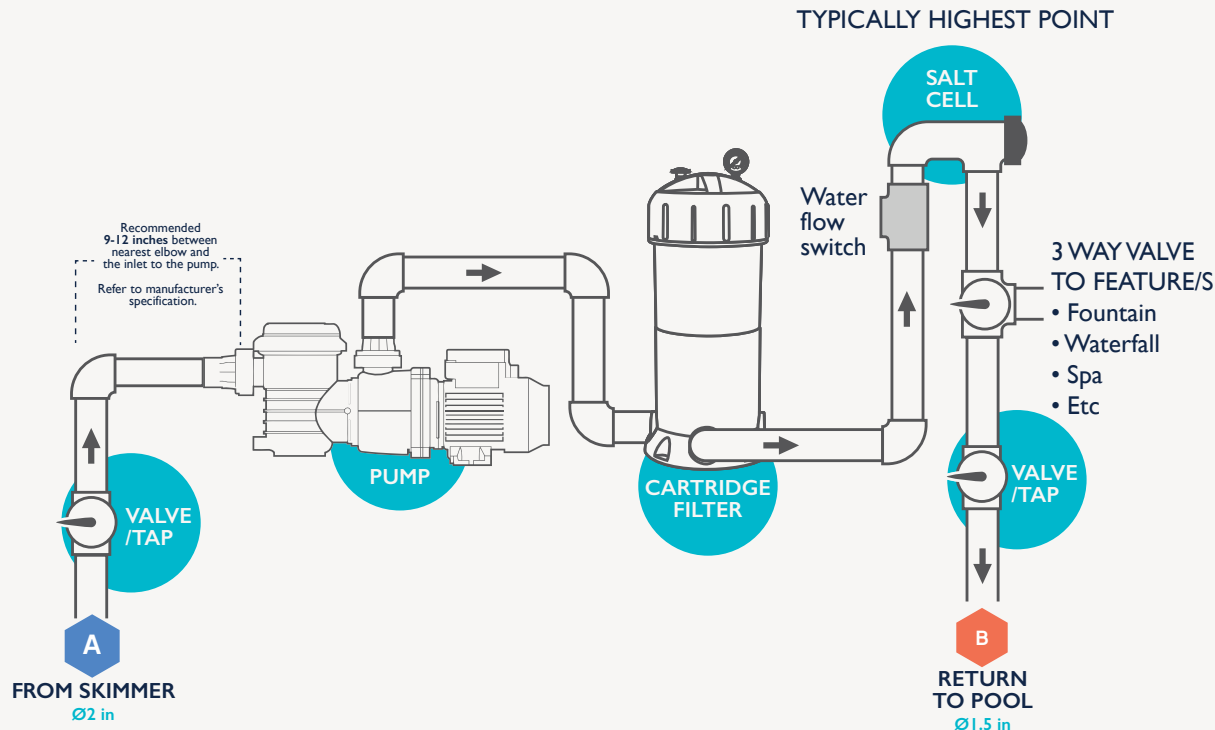

Things to note

- Salt cell is to be the highest point in the plumbing loop.
- A valve at the start and end of the plumbing loop is recommended when equipment is installed below pool water level.
- Pump size and settings (variable speed etc) do not alter equipment configuration.
- Cartridge filter can be substituted for media filter.
- The use of three-way valves and back flow devices can be added at the discretion of the plumber depending on owner usage requirements. Eg. Creating the ability to isolate heating and increase efficiencies

Refer to manufacturer instructions for specific installation requirements on equipment.

WHEN INSTALLED IN-LINE WITH EQUIPMENT

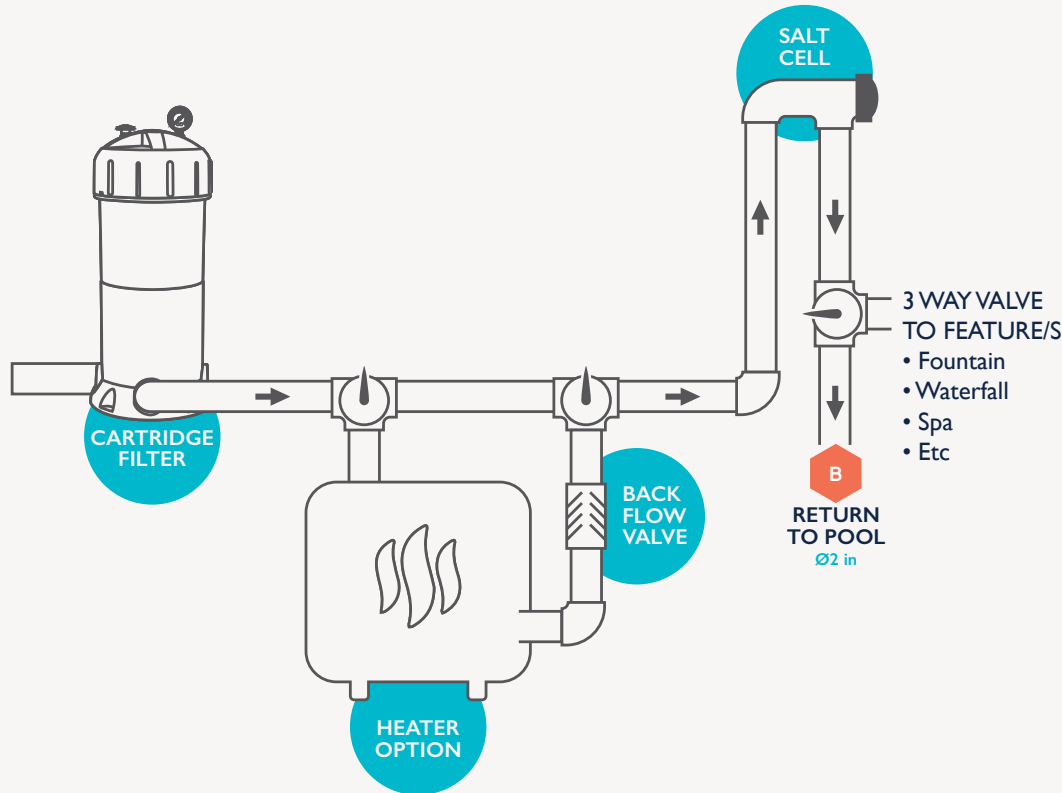

Things to note

- Transformer for LED Light will be supplied bubble wrapped inside your pool. Check for these contents before filling the pool for use.
- Conduit cable protection is required from pool to transformer installation point.
- The supplied transformer is suitable only for a single LED light.
- Electrical outlet is advised for lighting only. Refer to manufacturer's guidelines for all other electrical requirements, eg. heaters.
- Electrical work should be carried out by a licensed, trade qualified electrician.



Electrical work should be carried out by a licensed, trade qualified electrician.

TRANSFORMER:

Spa Electrics Argon N3P (Single LED transformer) Internal

LED LIGHT:

Spa Electrics Multi-Color (GK Series or APG)

INSTALLATION:

The information on the Plungie light is listed below:

Spa Electrics Light
Argon N3P 5.2" x 1.1"

- Refer to this link for the owners manual and installation guide:
<https://www.spaelectrics.com/product-manuals>

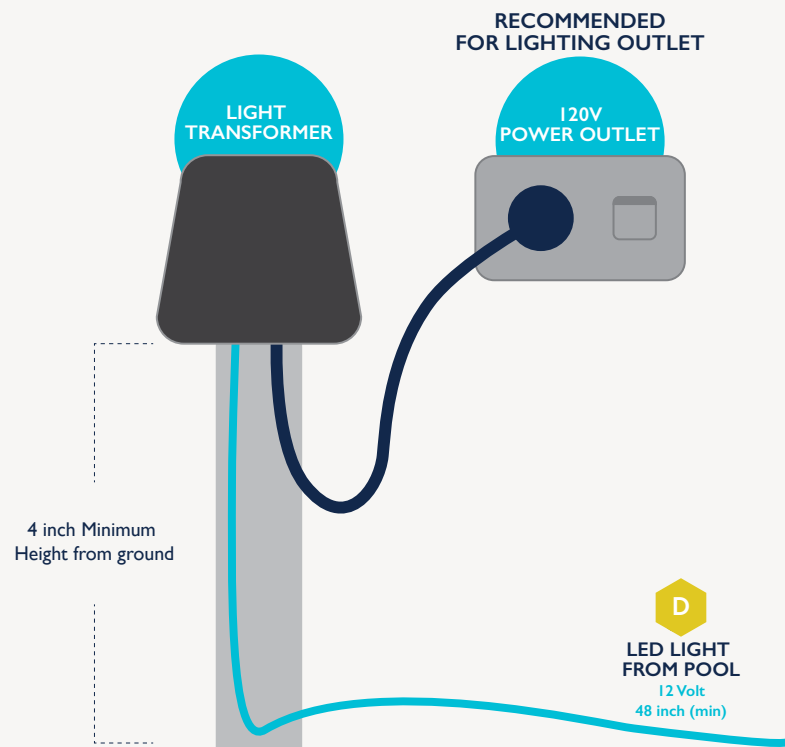

Things to note

The water overflow provision allows for the pool to be plumbed and prevent spill over during rain etc. Work to do so should be undertaken by a licensed plumber.

- Drill a hole through the back edge of the skimmer box in the location shown
- Connect 1" PVC piping and secure with a water tight bond (eg PVC Cement)
- Run plumbing to appropriate discharge location

ARENA:

Access to the overflow provision is via a conduit provision in the outer concrete shell.



Rules relating to the discharging of pool water varies by local regulations (eg storm water, sewer, etc). Please check with your local requirements before undertaking work.

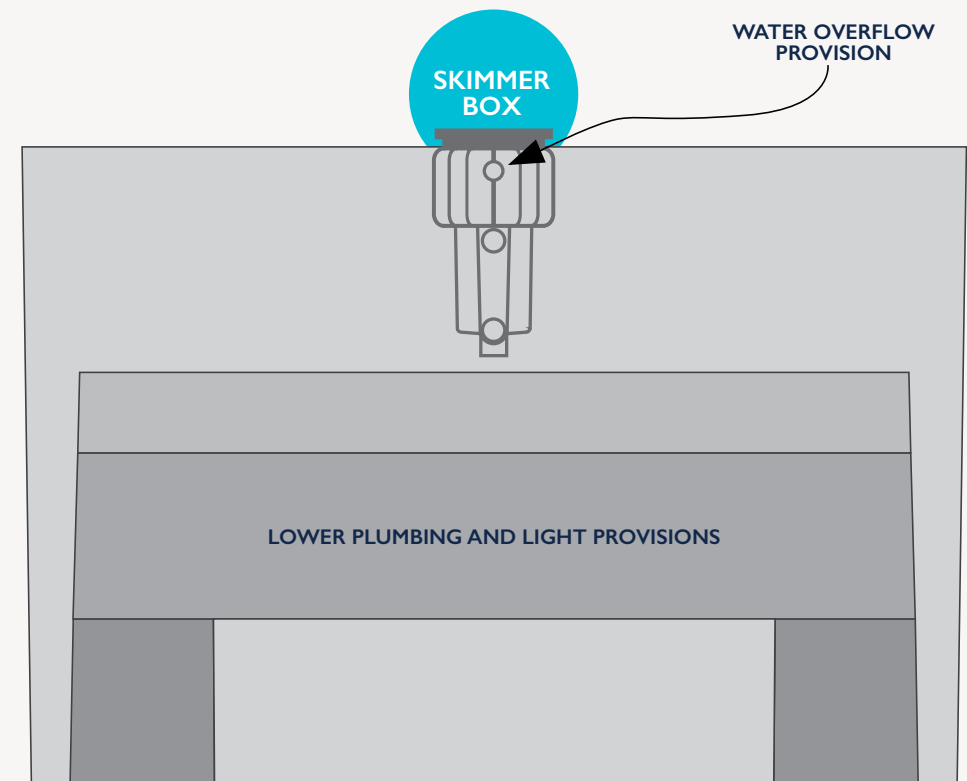



plungie.com/en-us
1300 PLUNGIE (758 644)