



Base Equipment Package

Hayward Cartridge C200S
Single speed pump
Hayward Chlorinator CL2002S
Hayward Three Way Valve
Hayward Check Valve



MaxFlo® XE

Ultra-High Efficiency Pumps

INDUSTRY-LEADING EFFICIENCY
AT AN INCOMPARABLE PRICE



EXPERT LINE®



ONLY FROM POOL PROS



3+ YEAR PARTS & LABOR WARRANTIES*

*When sold by a Totally Hayward® Partner. Exclusions, other terms and conditions may apply — visit hayward.com/expert for details.

THE ENERGY EFFICIENCY YOU NEED. THE VALUE YOU WANT.

For pool owners looking for impressive energy savings in a pump that costs a lot less, MaxFlo XE ultra-high efficiency pumps are a great find. Selectable speed options create powerful cost savings without a lot of hassle. With its easy installation, dual-voltage capability and durable design that's up to 30% lighter weight than competitive VS models, MaxFlo XE is the best way to install an affordable pump that complies with Department of Energy regulations in any new or existing pool.

KEY FEATURES

- » **Industry-leading efficiency** exceeds DOE benchmarks and efficiency of many competitive VS pumps
- » **Easily programmable** with up to 6 selectable speeds
- » **Dual-voltage capability** (230V/115V) offers more versatility for installation
- » **Chemical-resistant Viton® seal** offers improved resistance against chemical imbalances
- » **Simple installation** with up to 2" shorter length than single-speed models, standard 1.5" x 2" unions and no additional equipment requirements



Simple button programming
easily switches between speeds

EXPERT LINE®
ONLY FROM POOL PROS



SPECIFICATIONS

MODEL NUMBER	TOTAL HP	SPEED RANGE	VOLTAGE	WEIGHTED ENERGY FACTOR (WEF)*	WARRANTY
SP2310X15XE	1.65	40-100%	230/115V	9.7/9.7	3 years**
SP2315X20XE	2.25	40-100%	230/115V	8.4/8.7	3 years**

*The higher the weighted energy factor (WEF), the more efficient the pump. Visit hayward.com/regulations for more information.

MAXFLO XE DIMENSIONS (INCHES)

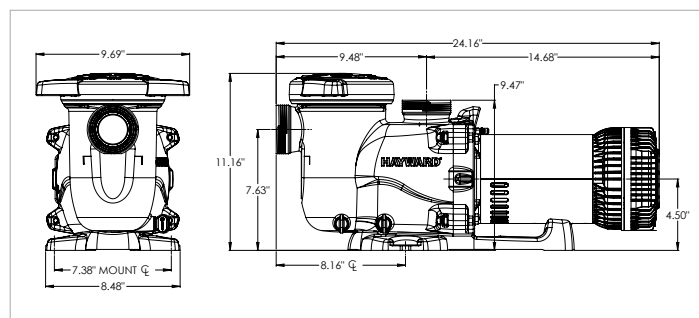

MAXFLO XE MAX SPEED PERFORMANCE COMPARISON

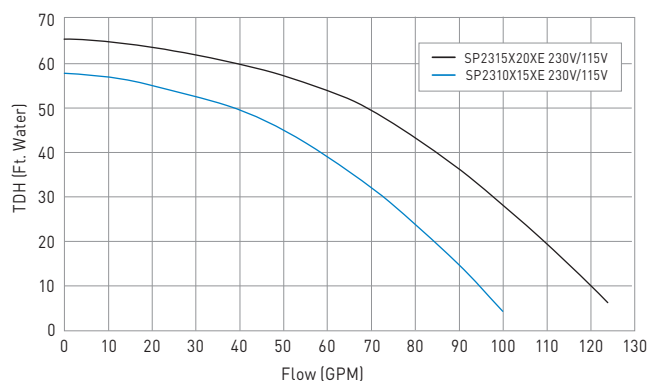

MaxFlo VS 500 pumps are listed by:

**When sold by a Totally Hayward® partner. Exclusions, other terms and conditions may apply — visit hayward.com/expert for details.

» hayward.com » 1-888-HAYWARD

Pumps » Filters » Heaters » Sanitization » Automation » Lighting » Water Features » Cleaners » Safety

Hayward, Hayward & Design, the H logo, Expert Line, MaxFlo, Totally Hayward and We Build Better. are registered trademarks of Hayward Industries, Inc. All other trademarks not owned by Hayward are the property of their respective owners. Hayward is not in any way affiliated with or endorsed by those third parties. © 2023 Hayward Industries, Inc.

LITTMFXE23

HAYWARD®
We Build Better.



SwimClear™

Single-Element Cartridge Filters

**LOWEST IN HEAD LOSS,
HIGHEST IN EFFICIENCY**



EXPERT LINE®



ONLY FROM POOL PROS



3+ YEAR PARTS & LABOR WARRANTIES*

*When sold by a Totally Hayward® Partner. Exclusions, other terms and conditions may apply — visit hayward.com/expert for details.



INCOMPARABLE EFFICIENCY

SwimClear™ filters are simply the most efficient single-element cartridge filters ever produced. Designed for greater hydraulic efficiency, they boast the industry's lowest head loss—saving pool owners more energy and money.



QUICK & EASY MAINTENANCE

A recessed pressure gauge and manual air relief allow for easy access to SwimClear's head assembly while also sealing the filter against contamination. And with the lowest body height on the market, cleaning and changing filter cartridges is easier than ever.



SIMPLE INSTALLATION

With 2" x 2½" union connections, SwimClear is quick and easy to retrofit in virtually any application. An Easy-Lok™ ring design and ergonomic handles offer confident filter handling while preventing contact with fiberglass-based surfaces.

SWIMCLEAR CARTRIDGE FILTERS

Filter Type	Cartridge element: 100 ft², 150 ft², 200 ft² [9.29 m², 13.94 m², 18.58 m²]
Filter Tank	High-strength, injection-molded, glass-reinforced copolymer
Filter Element	Reinforced polyester
Performance Range	100 to 120 GPM, 379 to 455 LPM
Union Connections	2" x 2 ½"
Dimensions	C100S: 30½" H x 18¼" W" [775 mm x 464 mm]**
	C150S: 33¾" H x 18¼" W" [857 mm x 464 mm]**
	C200S: 38¾" H x 18¼" W" [984 mm x 464 mm]**



FILTER PERFORMANCE DATA

MODEL NUMBER		EFFECTIVE FILTRATION AREA	DESIGN FLOW RATE***	TURNOVER		CLEARANCE FOR HEAD REMOVAL	CTN. WEIGHT
				8 HOURS	10 HOURS		
Residential	C100S	100 ft² / 9.29 m²	100 GPM / 379 LPM	48,000 gal / 182 kl	60,000 gal / 227 kl	12"	33 lbs.
	C150S	150 ft² / 13.94 m²	120 GPM / 455 LPM	57,600 gal / 218 kl	72,000 gal / 273 kl	15"	37 lbs.
	C200S	200 ft² / 18.58 m²	120 GPM / 455 LPM	57,600 gal / 218 kl	72,000 gal / 273 kl	18"	40 lbs.
Public	C100S	100 ft² / 9.29 m²	38 GPM / 142 LPM	18,240 gal / 68 kl	22,800 gal / 85 kl	12"	33 lbs.
	C150S	150 ft² / 13.94 m²	56 GPM / 213 LPM	26,880 gal / 102 kl	33,600 gal / 128 kl	15"	37 lbs.
	C200S	200 ft² / 18.58 m²	75 GPM / 284 LPM	36,000 gal / 136 kl	45,000 gal / 170 kl	18"	40 lbs.

*When sold by a Totally Hayward® partner. Exclusions, other terms and conditions may apply — visit hayward.com/expert for details.

**Based on NSF recommended rate for commercial use at .375 GPM/ft²

***Determined by pump size and piping system hydraulics; 2" piping is recommended for flow rates equal to or greater than 90 GPM [341 LPM]. Hayward doesn't recommend flow rates above 150 GPM.

» hayward.com » 1-888-HAYWARD

SwimClear Filters are listed by:



Pumps » Filters » Heaters » Sanitization » Automation » Lighting » Water Features » Cleaners » Safety

Hayward, Hayward & Design, the H logo, Expert Line, Totally Hayward and We Build Better. are registered trademarks and Easy-Lok and SwimClear is a trademark of Hayward Industries, Inc. All other trademarks not owned by Hayward are the property of their respective owners. Hayward is not in any way affiliated with or endorsed by those third parties. © 2023 Hayward Industries, Inc.

LITSCSE23





Chemical Feeders

»»» Automatic Chlorinators
and Brominators

EASY, ECONOMICAL
SANITIZATION FOR ANY POOL



HAYWARD® AUTOMATIC CHEMICAL FEEDER FEATURES

- » **Available for chlorine or bromine sanitization** using large or small slow-dissolving tablets
- » **9- and 4.2-lb chemical capacities** fit in-ground and above-ground pools and spas of all sizes
- » **Multiple in-line and off-line configurations** allow for simple installation in new construction, aftermarket and replacement applications
- » **Large dial control valve** allows for easy feed rate adjustment
- » **EasyLok™ threaded cover** provides safe and convenient access to tablets
- » **Chemical-resistant Viton® seal** and corrosion-resistant components provide heavy-duty durability

PERFORMANCE DATA

MODEL NUMBER	PIPE SIZE	CHEMICAL CAPACITY	FEEDER WIDTH	FEEDER HEIGHT
IN-LINE CHLORINATORS				
CL100	1½" FIP	4.2 lbs.	8¼"	15¼"
CL200*	1½" FIP	9 lbs.	9"	14¾"
CL2002S**	2" SKT	9 lbs.	9"	14¾"
OFF-LINE CHLORINATORS				
CL110	—	4.2 lbs.	6¾"	13"
CL220	—	9 lbs.	8¼"	15½"
OFF-LINE CHLORINATORS FOR ABOVE-GROUND POOLS***				
CL110ABG	—	4.2 lbs.	6¾"	13"
CL220ABG	—	9 lbs.	8¼"	15½"
OFF-LINE BROMINATORS				
CL220BR	—	9 lbs.	8¼"	15½"
ACCESSORIES				
SP1500UNMPAK1	Flush union connector with 1½" male nipple. For mounting in-line chlorine feeders.			
SP1500UNPAK2	Set of two flush union connectors. Fits CL100 and CL200 chlorinators inlet and outlet.			

IN-LINE AND OFF-LINE CONFIGURATIONS

To accommodate most capacity, plumbing and space considerations

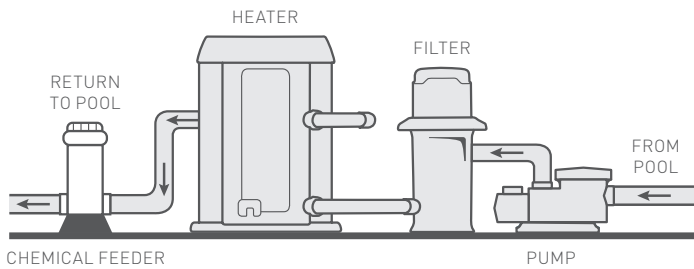

SP1500UNPAK2



IN-LINE INSTALLATION FOR CL100, CL200 AND CL2002S IN-LINE FEEDERS

Use 1-1/2" FIP ports to connect to filter system plumbing

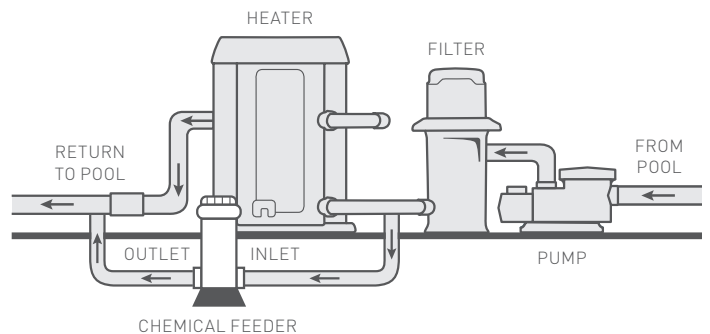

UNIVERSAL ADAPTER
KIT (ABOVE GROUND)

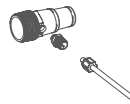

SADDLE CLAMP
ASSEMBLY

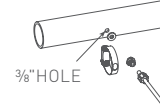

OFF-LINE INSTALLATION FOR CL110 AND CL220 OFF-LINE FEEDERS

Install next to filtration equipment and operate on system pressure differential

*Includes mounting base.

**Features 2" inlet and outlet ports for applications with 50 GPM to 90 GPM flow rates.

***Packaged with a universal adapter kit for all Hayward above-ground filter systems—Perflex®, sand or cartridge.

» hayward.com » 1-888-HAYWARD

Pumps » Filters » Heating » Cleaners » Sanitization » Automation » Lighting » Water Features » White Goods